

OREGON CORNER RESTORATION FORM

Section 7 Township 6S Range 8W

County Polk Date 1-7-86

Corner Designation

Section Corner 6 & 7

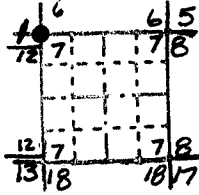

- Condition Report Only
- Not Found
- Renewed
- Unrecorded
- Surveyed In
- Referenced Out

Previous Renewals/Surveys, etc. 1856 Armstrong, 1880 Caudle, 1887 Fenton and Maloney, 1967 Hollingsworth, 1975 Polk County.

Monument(s) & Accessories Found: (Condition and Source)

- Fd: 2 3/4" brass cap on galv. iron pipe set by Polk County 1975.
- Fd: 19" fir N 22°E-23.0' with corner tag, no scribes visible.
- Fd: 26" fir stump-N 77 3/4°E-125.4' (now rotten-scribes not legible).
- Fd: 46" fir stump-S 16 1/2°E-68.0' (now rotten-no visible scribes).
- Fd: 26" fir S 18°E-14.4' with corner tag. No scribes visible.

Monument Detail

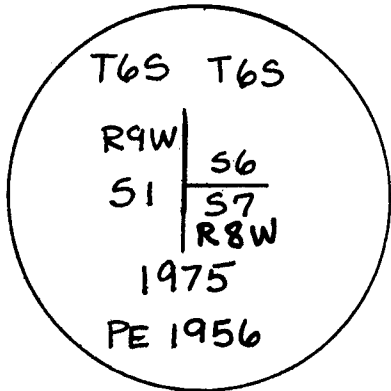

Sketch

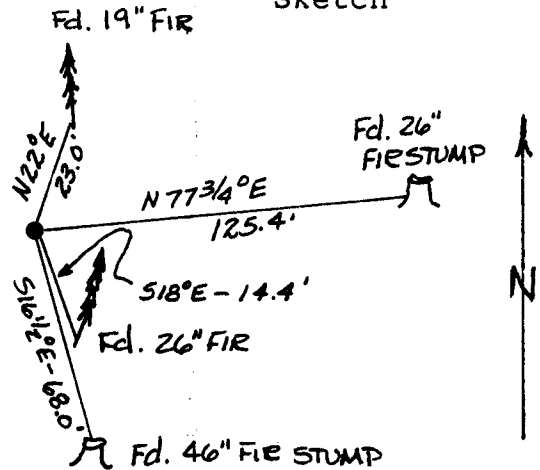

Monument Set (Procedures and Description)

New Accessories

Location & Comments

Van Duzer Corridor Compass Declination 20 1/2°
Distance and bearings by steel tape and hand compass. Firm/Agency Oregon State Parks & Recreation Division
Address 525 Trade St. SE
Salem, OR 97310
 Party Chief K. Thiel
 Notes K. Thiel
 Witness B. Bittner, H. Hanson

Surveyor's Seal

